



16 Flaxpiece Road, Clay Cross, Chesterfield, S45 9HB

£95,000 (Offers In Region Of)



DESCRIPTION

Calling all first time buyer!!

Two double bedroom terraced house - offered with NO CHAIN. Ready to move straight into, the property comprises: - open plan lounge/ diner, fitted kitchen.

Two first floor well proportioned bedrooms & bathroom.

Gas centrally heated & uPVC double glazed.

On street parking & rear patio. Close to local amenities & great for access to M1.

Excellent starter home - VIEW NOW!





GROUND FLOOR
36.9 sq.m. (397 sq.ft.) approx.

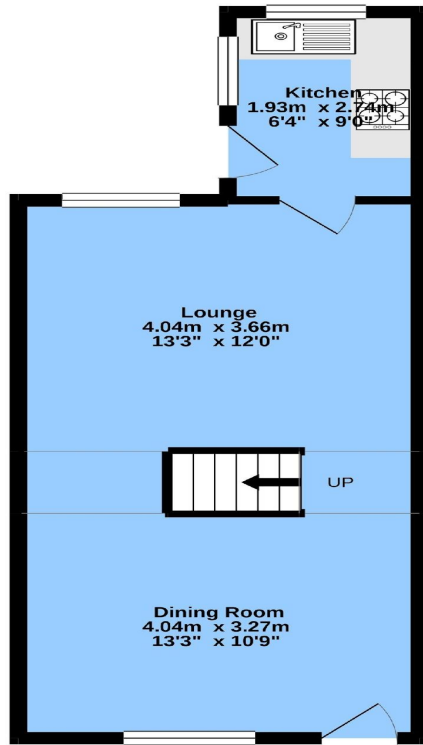

1ST FLOOR
36.9 sq.m. (397 sq.ft.) approx.

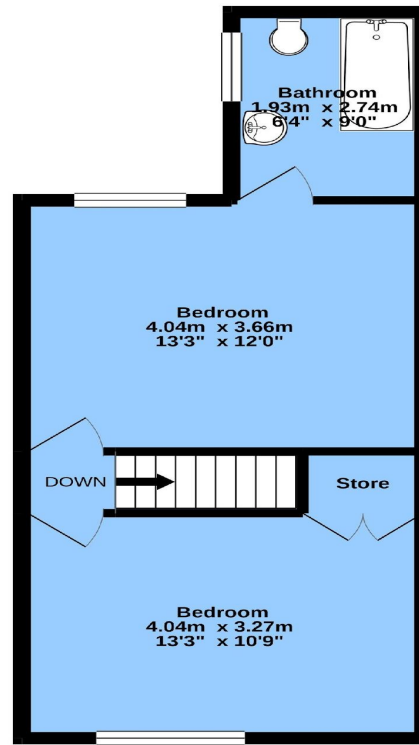

TOTAL FLOOR AREA : 73.8 sq.m. (794 sq.ft.) approx.

Whilst every attempt has been made to ensure the accuracy of the floorplan contained here, measurements of doors, windows, rooms and any other items are approximate and no responsibility is taken for any error, omission or mis-statement. This plan is for illustrative purposes only and should be used as such by any prospective purchaser. The services, systems and appliances shown have not been tested and no guarantee as to their operability or efficiency can be given.
Made with Metropix ©2021

Energy Performance Certificate

The energy efficiency rating is a measure of the overall efficacy of a home. The higher the rating the more energy efficient the home is and the lower the fuel bills will be.

DISCLAIMER

These particulars are intended to give a fair and reliable description of the property but no responsibility for any inaccuracy or error can be accepted and do not constitute an offer or contract. We have not tested any services or appliances (including central heating if fitted) referred to in these particulars and the purchasers are advised to satisfy themselves as to the working order and condition. If a property is unoccupied at any time there may be reconnection charges for any switched off/disconnected or drained services or appliances - All measurements are approximate.

Do you have a property
to sell or let?

If you are thinking of selling your home or just curious to discover the value of your property, Hunters would be pleased to provide free, no obligation sales and marketing advice. Even if your home is outside the area covered by our local offices we can arrange a Market Appraisal through our national network of Hunters estate agents.



01246 540540



34 - 36 Burlington Street, Chesterfield, S40 1RR



chesterfield@hunters.com



OPENING HOURS

Monday to Friday 9am - 5:15pm and
Saturday 9am - 4pm



VAT Reg. No 244501631 | Registered No: 8007057 | Registered Office: 34 - 36 Burlington Street, Chesterfield, S40 1RR
Hunters Chesterfield Spire Estates Ltd

MOVING YOU SINCE '92

Local expertise, national exposure

Thinking of moving this year?

Call us today to speak to
one of our property experts
or scan to book a valuation.



SCAN ME



Online. On the high-street. Over the phone.

📞 01246 540540
✉ chesterfield@hunters.com
🏠 hunters.com



- Celebrating 30 years -



* Full details at [hunters.com/terms-and-conditions](https://www.hunters.com/terms-and-conditions). If you are under contract with another agent you may still be liable to pay their fee.



We're not just a local business, we're
your local experts! We know the area
and we know what it takes to get the
right mortgage for you!

Contact your local expert adviser today

07825 142708

george.barnes@mab.org.uk

feefo
Customer Experience Rating

4.9^{/5}



Award-winning mortgage broker



* Mortgage Advice Bureau Feefo rating correct on 28th January 2020.
Your home may be repossessed if you do not keep up repayments on your mortgage.
There may be a fee for mortgage advice. The actual amount you pay will depend upon your circumstances.
The fee is up to 1% but a typical fee is 0.30% of the amount borrowed.