



8 Riber Close, Inkersall, Chesterfield, S43 3EU

NO CHAIN | 2 bed semi detached bungalow | NEEDS FULL REFURBISHMENT | Driveway parking
Detached garage | Front & rear gardens | Great location for amenities

Asking Price: £160,000



DESCRIPTION

Two bedroom semi detached
bungalow - NO CHAIN.
IN NEED OF FULL
REFURBISHMENT.

Comprising: - lounge, kitchen, inner
hall, two bedrooms, shower room,
conservatory.

Driveway parking, detached garage
& gardens to the front & rear.
Ideal for access to Chesterfield &
Sheffield.

VIEWINGS AVAILABLE NOW -
come & put your own stamp to it.





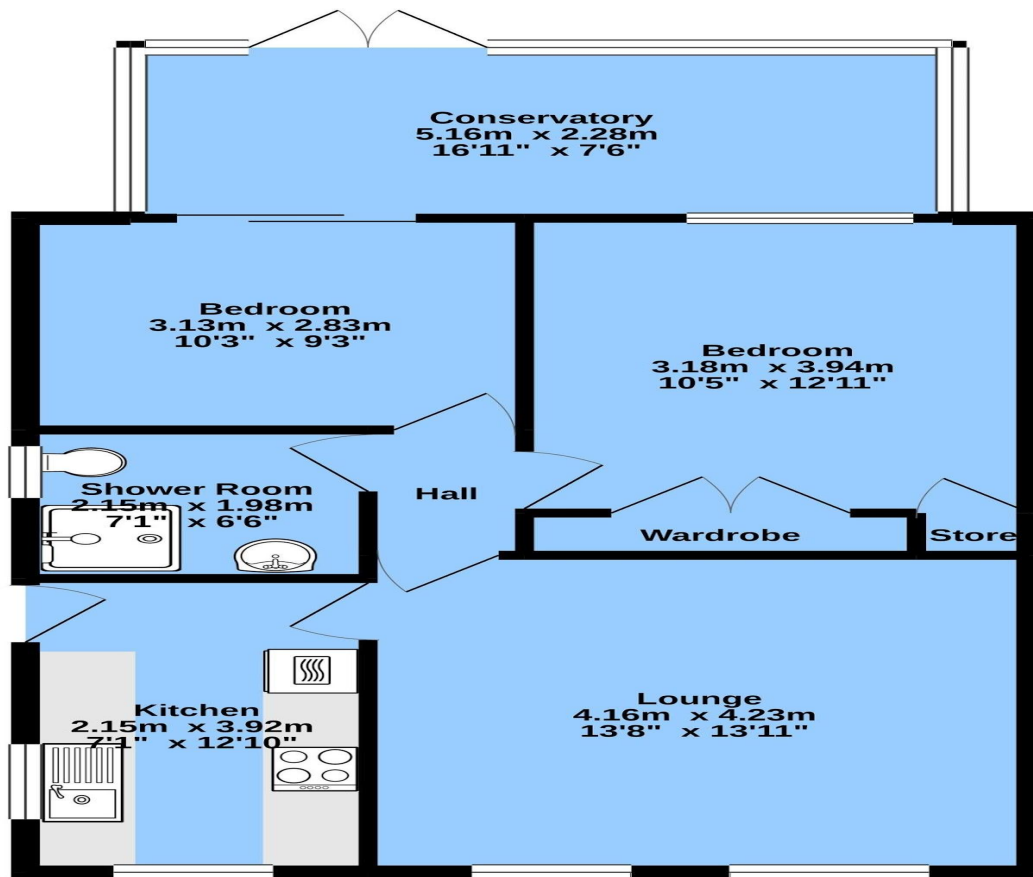

TOTAL FLOOR AREA : 66.9 sq.m. (720 sq.ft.) approx.
Measurements are approximate. Not to scale. Illustrative purposes only
Made with Metropix ©2021

Energy Performance Certificate

The energy efficiency rating is a measure of the overall efficacy of a home. The higher the rating the more energy efficient the home is and the lower the fuel bills will be.

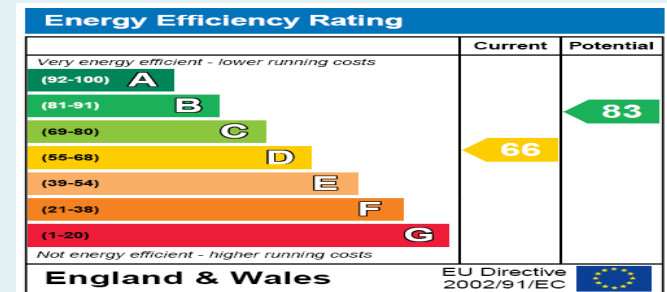

DISCLAIMER

These particulars are intended to give a fair and reliable description of the property but no responsibility for any inaccuracy or error can be accepted and do not constitute an offer or contract. We have not tested any services or appliances (including central heating if fitted) referred to in these particulars and the purchasers are advised to satisfy themselves as to the working order and condition. If a property is unoccupied at any time there may be reconnection charges for any switched off/disconnected or drained services or appliances - All measurements are approximate.

Do you have a property
to sell or let?

If you are thinking of selling your home or just curious to discover the value of your property, Hunters would be pleased to provide free, no obligation sales and marketing advice. Even if your home is outside the area covered by our local offices we can arrange a Market Appraisal through our national network of Hunters estate agents.



01246 540540

34 - 36 Burlington Street, Chesterfield, S40 1RR



chesterfield@hunters.com



OPENING HOURS

Monday to Friday 9am - 5:15pm and Saturday
9am - 4pm



VAT Reg. No 244501631 | Registered No: 8007057 | Registered Office: 34 - 36 Burlington Street, Chesterfield, S40 1RR
Hunters Chesterfield Spire Estates Ltd